

# Heritage Product Range

## Hinged Unit

Our most discreet secondary glazing product, featuring single handle operation and multi-point locking. Side and base opening is available, plus there is a tilt and turn facility for easy maintenance.

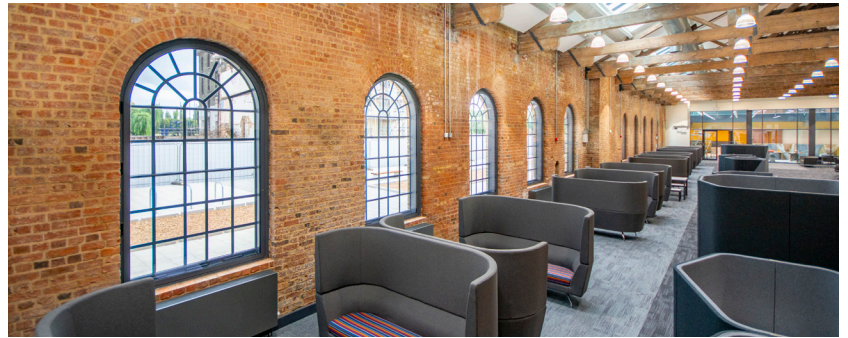
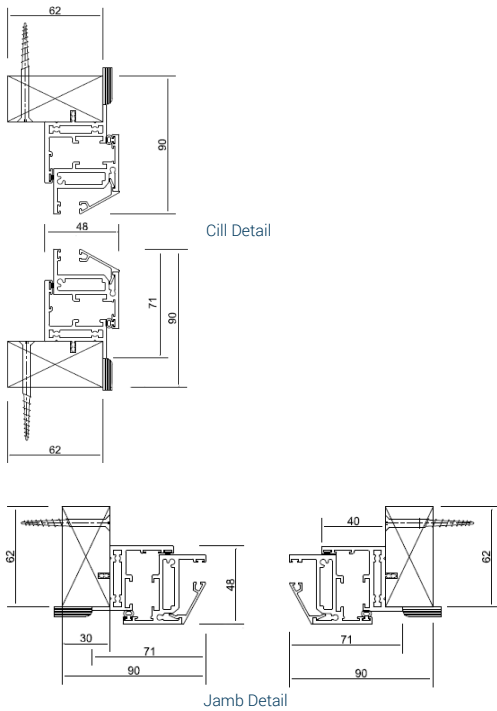

### Features

- Slim, unobtrusive aluminium profile
- Easy opening due to internal gearing
- Multi-point locking for enhanced security
- Improved noise and thermal installation
- Suitable for arched and shaped applications
- Suitable to have bevelled timber subframe to fix into bays /splayed reveals
- Can be coupled or stacked with other units in the range to treat large areas of glazing or long runs of windows
- Can be supplied with restrictors

### Variations of Basic Unit

- Various handle and hinge options
- Tilt & Turn, Anti Ligature and Double Hinged (DHHU) options
- Standard and acoustic trickle vents are available
- No subframe version available
- Larger PVCu trims and timber trims available at an additional cost
- Can be coupled and stacked using a heavy duty frame coupling section or timber to timber
- Variety of stock colours available, including all RAL options
- LH, RH, top or bottom orientation
- Can accept flyscreen mesh

### Specification

- Glazing options: 4mm - 8.8mm or double glazed
- Choice of timber subframes
- Pre-drilled and countersunk to suit either face fix or reveal fix
- Woolpile inserted into panel section groove to create outer frame seal
- Gasket colour option of black or white
- PVCu trims supplied for the face of the units to create a neat, clean finish
- Standard colour white high gloss - RAL 9910



#### Optimum Noise Reduction: 54dB (Rw)

Using 6.4mm acoustic laminate glazing, with 200mm glass-to-glass



#### Optimum U Value: 0.8 W/m<sup>2</sup>K

Using 4mm toughened Low E glazing, with 80mm glass-to-glass

Heritage Configurations

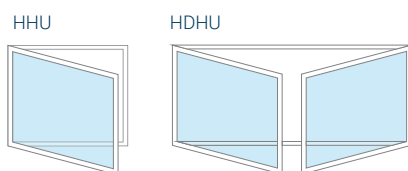

Based on 4mm Glass

Max width:	1,400mm	2,800mm
or Max height:	2,400mm	2,800mm